

T.M. Goodwin Waterfowl

Management Area

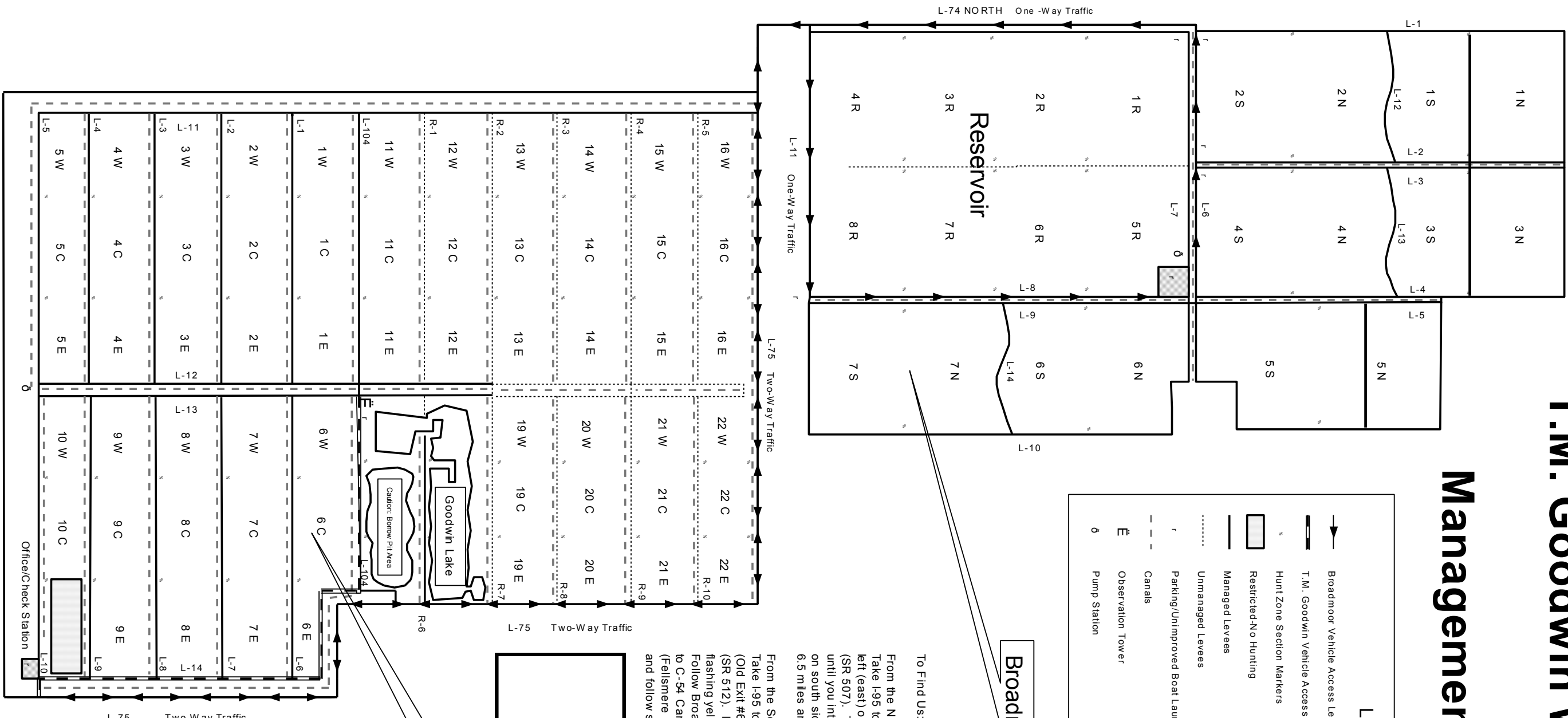

Legend

- Broadmoor Vehicle Access Levees, Thursdays 9:00 AM to 4:00 PM
- T.M. Goodwin Vehicle Access Levees, Mondays and Thursdays 9:00 AM to 4:00 PM
- Hunt Zone Section Markers
- Restricted-No Hunting
- Managed Levees
- Unmanaged Levees
- Parking/Unimproved Boat Launch Areas
- Canals
- Observation Tower
- Pump Station

Broadmoor Marsh Unit

To Find Us:

From the North:
 Take I-95 to Malabar, Exit #173 (Old Exit #70). Turn left (east) on Malabar Road to Babcock Street (SR 507). Turn right (south) for about 1.5 miles until you intersect the C-54 Canal. Turn right (west) on south side of canal (Fellsmere Grade) for about 6.5 miles and follow signs to the T.M. Goodwin WMA.

From the South:
 Take I-95 to Sebastian/Fellsmere, Exit #156 (Old Exit #69) and turn left (west) on Fellsmere Road (SR 512). In Fellsmere, turn right (north) at the second flashing yellow light on Broadway Street (SR 507). Follow Broadway Street, which turns into SR 507, to C-54 Canal and turn left (west) on south side of canal (Fellsmere Grade). Continue west for about 6.5 miles and follow signs to the T.M. Goodwin WMA.

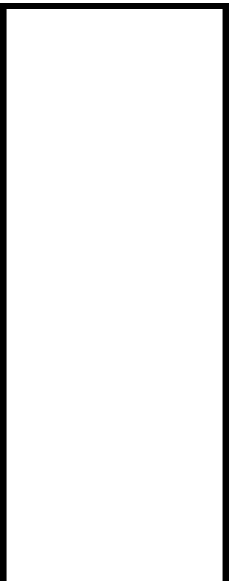

T.M. Goodwin Unit

Note: All T.M. Goodwin and Broadmoor Marsh hunters must check in/out at the Check Station.

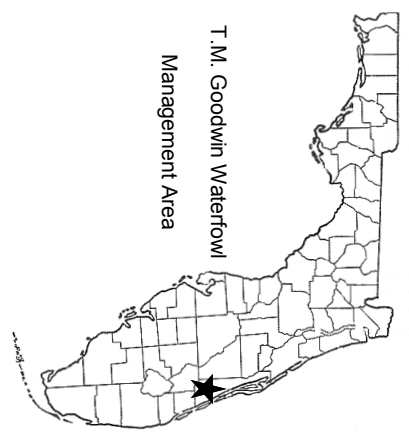

< Entrance